

- 1 - GENERAL NOTES
1.

Construction shall comply with all applicable codes and industry standards as noted in the contract documents. The consulting structural engineer assumes no responsibility for the consequences of failure by the contractor/owner to build in strict conformance with the contract documents and drawings.
2.

The contractor shall review all contract documents in conjunction for errors or omissions and shall verify all dimensions and review documentation for discrepancies. Contact the engineer and design team for clarification prior to construction. All unreported discrepancies are the responsibility of the contractor.
3.

All structural design is limited to the structural components shown on these drawings. Design of components not clearly identified on these drawings is to be done by the supplier of those components and fastened to the structure as per the supplier's specifications within the parameters shown on these drawings. If there is any ambiguity, consult the structural engineer.
4.

The structure is designed to resist the design loads once completed. All bracing and support necessary for construction is the responsibility of the contractor.
5.

Use only drawings that have been prepared specifically for construction and are labeled as such.
6.

Detail marker represented as  shall be read as detail #1 on page S6.
7.

See architectural drawings for floor and roof elevations and sections, recesses, drainage slopes, etc.
8.

Any submissions noted *issued for permit* are provided for permitting purposes only and may not be fully complete. Minor revisions may be made prior to issuing for construction.
9.

The following notes in the various sub-categories of general notes are to be followed unless noted otherwise. If unclear, consult with the engineer.
10.

Any submissions noted issued for permit are provided for permitting purposes only. For construction, refer to the issued for construction plans and supporting documents.

- 2 - DESIGN DATA
1.

The structural components in this drawing package have been designed in accordance with the following codes:

a. BCBC 2018
2.

Climatic data used for the design of these structural components:

Location: Duncan, BC

Snow: Ss = 1.8 kPa

Wind: q50 = 0.39 kPa

Sr = 0.4 kPa

Seismic: Sa(0.2) = 1.17Sa(0.5) = 1.09PGA = 0.513Rd = 3, Ro = 1.7

Sa(1.0) = 0.631Sa(2.0) = 0.378Site Class = C

Wood shearwall
3.

Soil bearing capacity is assumed to be as follows and should be verified by a geotechnical engineer or other suitable individual:

Serviceability Bearing Capacity (SLS) = 75 kPa

Ultimate Bearing Capacity (ULS) = 110 kPa
4.

Dead and Live Loading is as follows:

Roof: dead: framing, roofing, hardware = 0.55 kPa

electrical, insulation, etc. = 0.15 kPa

total dead load = 0.70 kPa

live: Design Snow (Cb = 0.55) = 1.45 kPa

Floor: dead: framing, hardware, flooring = 0.6 kPa

live: residential occupancy = 1.9 kPa

Decks: dead: framing, hardware = 0.55 kPa

live: residential = 2.4 kPa

- 3 - CONSTRUCTION REVIEWS
1.

Do not cover up any structural elements until buepoint has been given the opportunity to review construction. Cover up of structural elements without review by buepoint may require those components to be exposed for review if deemed necessary by buepoint. Cover up may include but is not limited to:

a. pouring concrete.

b. insulating.

c. sheathing, decking, siding.

Contact buepoint if you have any questions.

Please notify buepoint 3 business days in advance for site visits.
2.

Site visits may be performed by proxy at the discretion of buepoint.
3.

All site instructions must come from the signing engineer (EOR).
4.

All changes to construction drawings must be accompanied by a written instruction from buepoint.
5.

Changes made without a written site instruction from the signing engineer may be considered unacceptable.
6.

At the discretion of the engineer, structural steel welds and bolt installation may be required to be inspected by an independent testing agency at the expense of the owner.

DRAWING LIST

S0	Cover sheet	for review	2021.12.09
S1	Split panel plan	for review	2021.12.09
S2	Stud panel joint elevations	for review	2021.12.09
S3	Stud panel joint elevations	for review	2021.12.09

- ABBREVIATIONS
- AIFB

asphalt impregnated fiberboard
- ARCH

architectural plans
- BCBC

British Columbia Building Code
- B/W

between
- CANT

cantilever
- CLR

clearance
- CONT

continuous
- CSA

Canadian Standards Association
- C, TIE

collar tie
- C/W

complete with
- FH

full height
- FND

foundation
- FTG

footing
- ICF

insulated concrete forms
- KP

king post
- LVL

laminated veneer lumber
- O/C

on center
- OSB

oriented strandboard
- PR

principal rafter
- PSL

parallel strand lumber
- P.T.

pressure treated
- R/W

reinforced with
- SIM

similar
- SIP

structural insulated panel
- SOG

slab-on-grade
- T&G

tongue and groove
- TYP

typical
- U.N.O.

unless noted otherwise



35

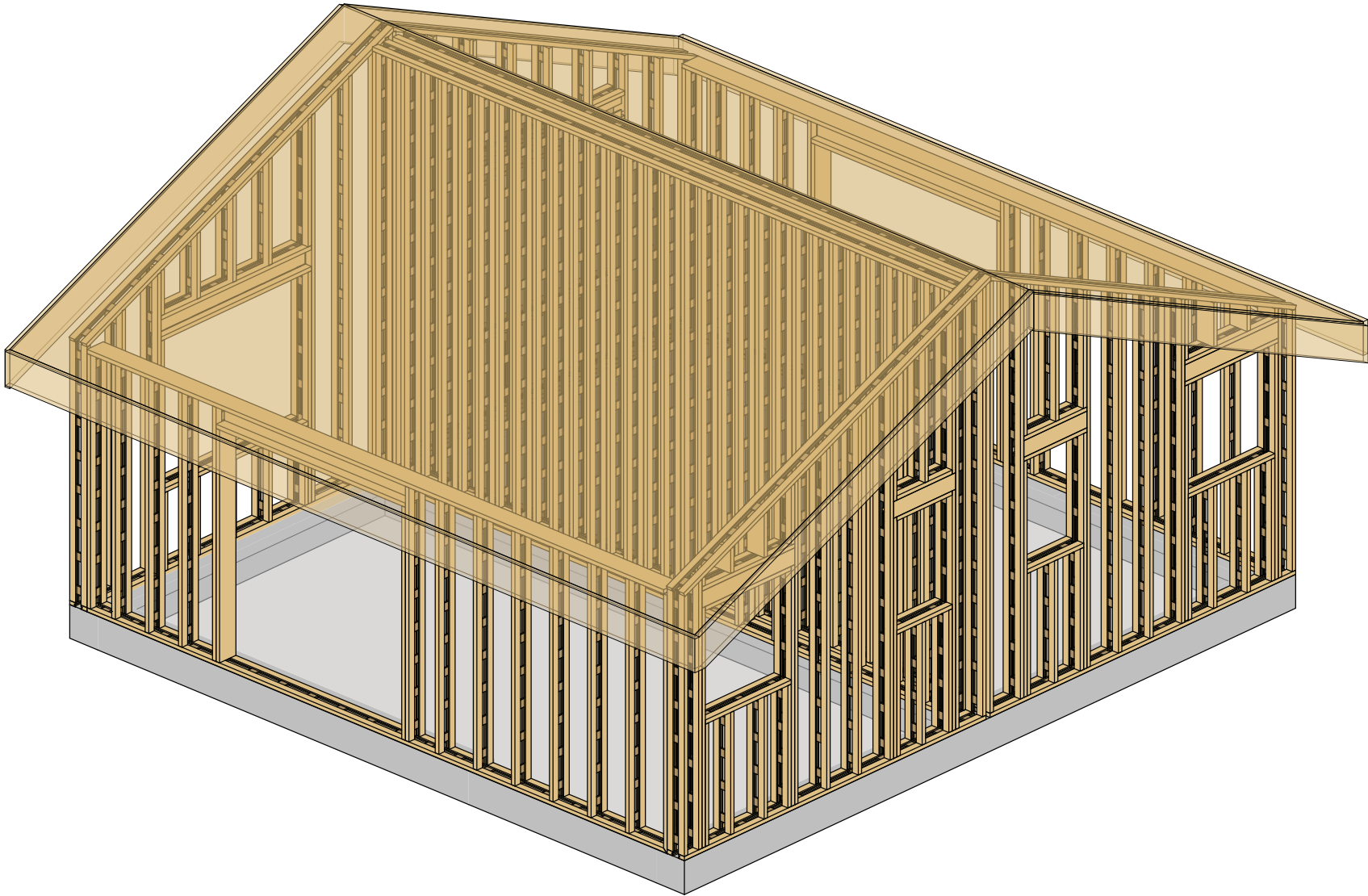

3d cover 2

NOT FOR CONSRUCTION  
FOR INFORMATION ONLY

Residence

address

bpc # 11264

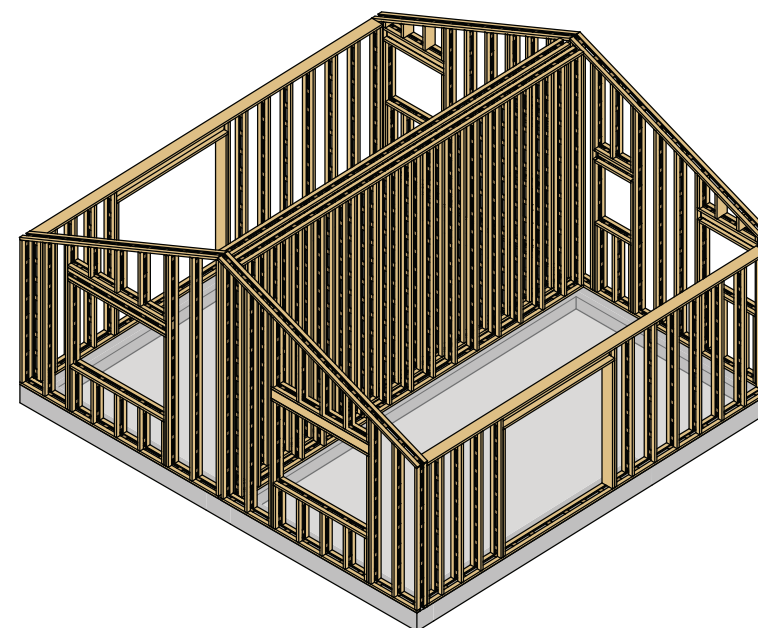
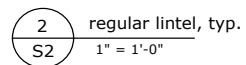
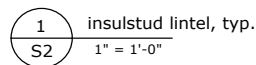
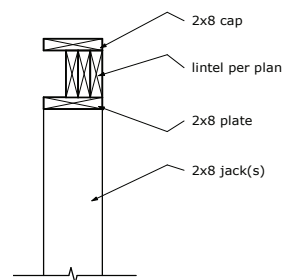
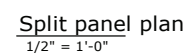
[illegible]

SEAL:

NOT FOR CONSTRUCTION  
FOR INFORMATION ONLY

(C) COPYRIGHT RESERVED.  
THIS PLAN AND DESIGN ARE, AND AT ALL TIMES,  
THE EXCLUSIVE PROPERTY OF BLUEPOINT CONSULTING  
REPRODUCTION OR USE WITHOUT WRITTEN CONSENT  
IS PROHIBITED. CONTRACTOR SHALL VERIFY AND BE  
RESPONSIBLE FOR ALL DIMENSIONS AND CONDITIONS  
ON PROJECT AND THIS OFFICE SHALL BE INFORMED  
OF ANY VARIATIONS FROM DIMENSIONS AND CONDITIONS  
SHOWN ON THE DRAWING. DO NOT SCALE DRAWING.

PROJECT TITLE:

## Residence

address

DRAWING TITLE:

### Split panel plan

DESIGNED BY:	MB
CHECKED BY:	MB
DRAWN BY:	PA
PROJECT NO:	11264
DATE:	2021.11.25
SCALE:	As indicated
DRAWING NO.	

# S1

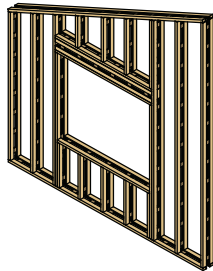

Panel A1

---

1/2" = 1'-0"

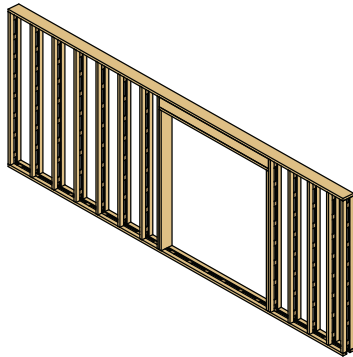

Panel A2

---

1/2" = 1'-0"

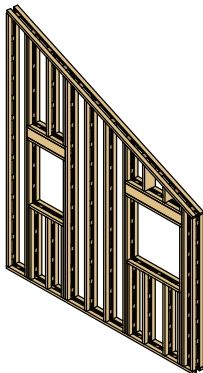

Panel A3  
1/2" = 1'-0"

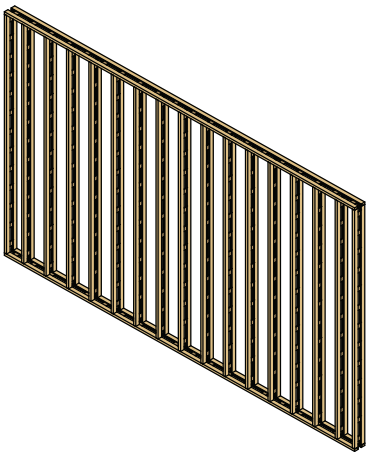

Panel A4  
1/2" = 1'-0"



**ProFrame™**  
Thermal Break Wall System

NOT FOR CONSTRUCTION  
FOR INFORMATION ONLY

address

## Stud panel joint elevations

DRAWING NO.

# S2



**ProFrame™**  
Thermal Break Wall System

NOT FOR CONSTRUCTION  
FOR INFORMATION ONLY

PROJECT TITLE:  
**Residence**  
address

### Stud panel joint elevations

### S3

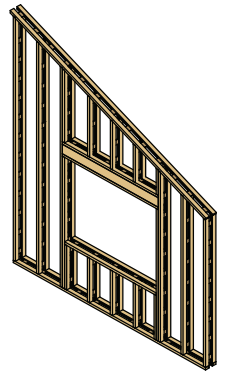

INSULSTUD WALL-B1		
Type	Count	Length
insulstud	1	1' - 4"
insulstud	1	1' - 11 1/2"
insulstud	5	2' - 4"
insulstud	1	2' - 6 1/2"
insulstud	1	3' - 1 3/4"
insulstud	1	3' - 9 1/2"
insulstud	1	5' - 4"
insulstud	2	5' - 7"
L2	1	5' - 7"
insulstud	2	6' - 10 1/4"
insulstud	1	7' - 8 3/4"
insulstud	1	8' - 3 3/4"
insulstud	1	8' - 10 3/4"
insulstud	1	11' - 2 1/2"
insulstud	1	11' - 5 3/4"
insulstud	1	12' - 1"
insulstud	1	12' - 6 1/4"
insulstud	1	12' - 8 3/4"

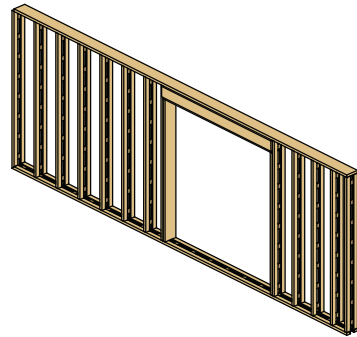

INSULSTUD WALL- B2		
Type	Count	Length
L2	1	6' - 7 1/2"
2x8	1	6' - 9"
2x8	2	6' - 10 3/4"
insulstud	13	7' - 6 1/4"
2x8	1	20' - 2 1/2"
insulstud	1	20' - 4"

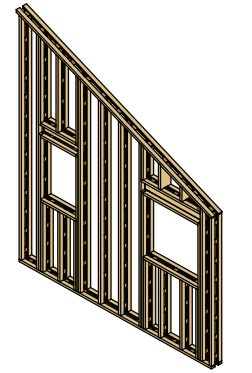

INSULSTUD WALL-B3		
Type	Count	Length
insulstud	1	0' - 3 1/4"
insulstud	1	0' - 9"
insulstud	1	1' - 3 3/4"
insulstud	1	1' - 9"
insulstud	3	2' - 0 3/4"
L1	1	2' - 3 3/4"
insulstud	2	3' - 2 1/4"
insulstud	1	3' - 5 1/4"
L2	1	3' - 5 1/4"
insulstud	1	3' - 7 1/4"
insulstud	7	3' - 7 1/2"
insulstud	1	4' - 0"
insulstud	1	4' - 7"
insulstud	4	7' - 1 1/4"
insulstud	1	7' - 8 1/2"
insulstud	1	7' - 11 1/4"
insulstud	1	9' - 6 3/4"
insulstud	1	10' - 1"
insulstud	1	10' - 7 1/4"
insulstud	1	11' - 1 3/4"
insulstud	1	11' - 2 1/2"
insulstud	1	12' - 3"
insulstud	1	12' - 6 1/4"
insulstud	1	12' - 8 1/4"

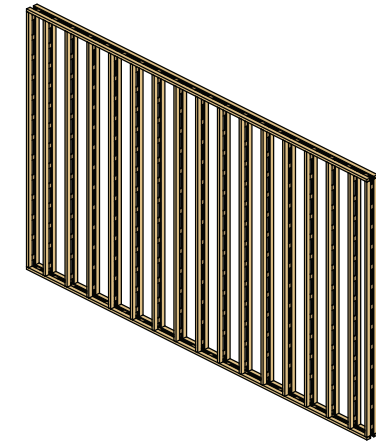

INSULSTUD WALL-B4		
Type	Count	Length
insulstud	17	12' - 6 1/4"
insulstud	2	20' - 4"